

Guia Linear

Av. Corifeu de Azevedo Marques, 4259/4279
Butantã, São Paulo – SP – CEP 05339-002

Tel/Fax.: (55 11) 5566-0266
www.sferatech.com.br



Características da Guia Linear SFT

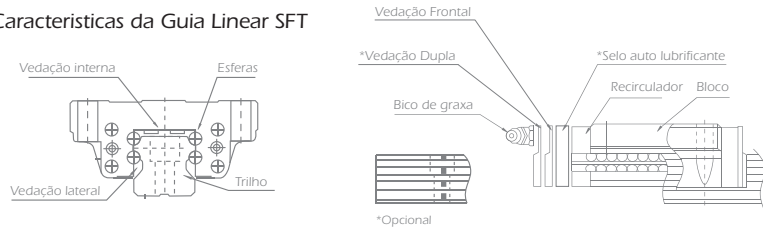

Codificação

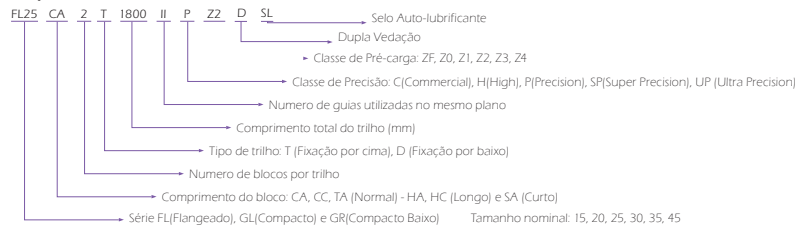

Classificação de precisão da Guia Linear SFT



Tabela de Pré-carga

Classe	Código	Pré-carga	Precisão
Folga mínima	ZF	Folga 0-0.01mm	C
Sem folga	Z0	0	C ~ UP
Pré-carga leve	Z1	0.02C	C ~ UP
Pré-carga média	Z2	0.05C	H ~ UP
Pré-carga alta	Z3	0.08C	H ~ UP

Tabela de paralelismo da Guia Linear SFT

Comprimento do trilho (mm)	Classificação de Precisão (µm)				
	C	H	P	SP	UP
~100	12	7	3	2	2
100-200	14	9	4	2	2
200-300	15	10	5	3	2
300-500	17	12	6	3	2
500-700	20	13	7	4	2
700-900	22	15	8	5	3
900-1100	24	16	9	6	3
1100-1500	26	18	11	7	4
1500-1900	28	20	13	8	4
1900-2500	31	22	15	10	5
2500-3100	33	25	18	11	6
3100-3600	36	27	20	14	7
3600-4040	37	28	21	15	7

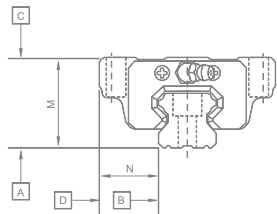
Unidade(mm)		FL-GL-GR-15 / 20 / 25 / 30 / 35 / 45				
Ítems		Commercial (C)	High (H)	Precision (P)	Super Precision (SP)	Ultra Precision (UP)
Tolerância dimensional para altura M		±0.1	±0.04	0 -0.04	0 -0.02	0 -0.01
Tolerância dimensional para largura N		±0.1	±0.04	0 -0.04	0 -0.02	0 -0.01
Pares	Diferença na altura M	0.02	0.015	0.007	0.005	0.003
	Diferença na largura N	0.02	0.015	0.007	0.005	0.003
Classe de Pré-carga	ZF, Z0, Z1	Z0-Z4				
Paralelismo da superfície C em relação à superfície A		Detalhes na tabela de paralelismo				
Paralelismo da superfície D em relação à superfície B		Detalhes na tabela de paralelismo				

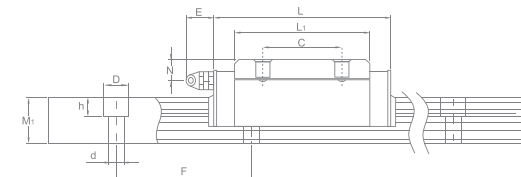
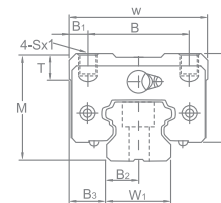
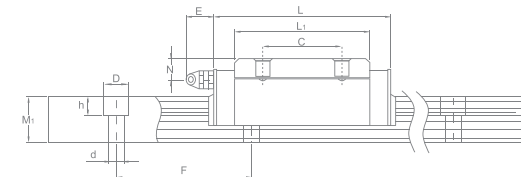
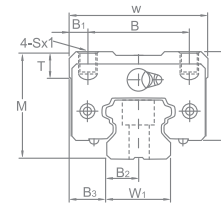
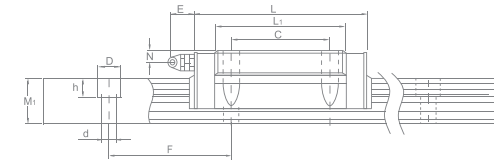
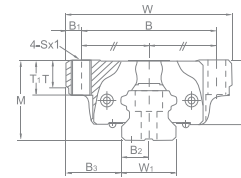



▪ **Modelo Flangeado FL**

Dimensões do bloco SFT / Dimensões do trilho SFT / mm

Modelo	Largura (W)	Comprimento (L)	Altura (M)	B	B ₁	L ₁	C	T	T ₁	T ₂	Sx1	N	E	Bico de graxa	Largura (W ₁)
FL15 CC	47	56.2	24	38	4.5	38.2	30	7	11	19.5	M5x1	4.5	5.5	M4x0.7P	15
FL20 CC	63	76.5	30	53	5	50.5	40	10	10	24.5	M6x10	5	12	M6x1.0P	20
FL20 HC	63	92.5	30	53	5	66.5	40	10	10	24.5	M6x10	5	12	M6x1.0P	20
FL25 CC	70	84.2	36	57	6.5	58	45	12	16	29.0	M8x16	6	12	M6x1.0P	23
FL25 HC	70	103.2	36	57	6.5	77	45	12	16	29.0	M8x16	6	12	M6x1.0P	23
FL30 CC	90	100.5	42	72	9	70.5	52	12	18	34.0	M10x18	7	12	M6x1.0P	28
FL30 HC	90	122.5	42	72	9	92.5	52	12	18	34.0	M10x18	7	12	M6x1.0P	28
FL35 CC	100	105.5	48	82	9	80.5	62	13	21	39.0	M10x21	8	12	M6x1.0P	34
FL35 HC	100	130.5	48	82	9	105.5	62	13	21	39.0	M10x21	8	12	M6x1.0P	34
FL45 CC	120	128.2	60	100	10	99.2	80	14	25	48.5	M12x25	10	16	1/8 PT	45
FL45 HC	120	159.5	60	100	10	130.5	80	14	25	48.5	M12x25	10	16	1/8 PT	45

▪ **Modelo Compacto GL**

Dimensões do bloco SFT / Dimensões do trilho SFT / mm

Modelo	Largura (W)	Comprimento (L)	Altura (M)	B	B ₁	L ₁	C	T	T ₂	Sx1	N	E	Bico de graxa	Largura (W ₁)	Altura (M ₁)
GL15 CA	34	56.2	28	26	4	38.2	26	6	23.5	M4x5	8.5	5.5	M4x0.7P	15	15
GL20 CA	44	76.5	30	32	6	50.5	36	8	24.5	M5x6	5	12	M6x1.0P	20	18
GL20 HA	44	92.5	30	32	6	66.5	50	8	24.5	M5x6	5	12	M6x1.0P	20	18
GL25 CA	48	84.2	40	35	6.5	58	35	12	33.0	M6x8	10	12	M6x1.0P	23	22
GL25 HA	48	103.2	40	35	6.5	77	50	12	33.0	M6x8	10	12	M6x1.0P	23	22
GL30 CA	60	94.2	45	40	10	70.5	40	12	37.0	M8x10	10	12	M6x1.0P	28	26
GL30 HA	60	122.5	45	40	10	92.5	60	12	37.0	M8x10	10	12	M6x1.0P	28	26
GL35 CA	70	105.5	55	50	10	80.5	50	12	46.0	M8x12	15	12	M6x1.0P	34	29
GL35 HA	70	130.5	55	50	10	105.5	72	12	46.0	M8x12	15	12	M6x1.0P	34	29
GL45 CA	86	128.2	70	60	13	99.2	60	15	58.5	M10x17	20	16	1/8 PT	45	38
GL45 HA	86	159.5	70	60	13	130.5	80	15	58.5	M10x17	20	16	1/8 PT	45	38

▪ **Modelo Compacto Baixo GR**

Dimensões do bloco SFT / Dimensões do trilho SFT / mm

Modelo	Largura (W)	Comprimento (L)	Altura (M)	B	B ₁	L ₁	C	T	T ₂	Sx1	N	E	Bico de graxa	Width (W ₁)	Altura (M ₁)
GR15 TA	34	56.2	24	26	4	38.2	26	6	19.5	M4x5	4	5.5	M4x0.7P	15	15
GR15 SA	34	39.2	24	26	4	21.3	-	6	19.5	M4x5	4	5.5	M4x0.7P	15	15
GR20 TA	42	67.2	28	32	5	47.2	32	7.5	22.5	M5x6	4	12	M6x1.0P	20	18
GR20 SA	42	47.5	28	32	5	27.5	-	7.5	22.5	M5x6	4	12	M6x1.0P	20	18
GR25 TA	48	79.5	33	35	6.5	59.5	35	8	26	M6x8	4.5	12	M6x1.0P	23	22
GR25 SA	48	55.0	33	35	6.5	35.0	-	8	26	M6x8	4.5	12	M6x1.0P	23	22
GR30 TA	60	92.5	42	40	10	69.0	40	9	34	M8x10	7	12	M6x1.0P	28	26
GR30 SA	60	63.5	42	40	10	40.5	-	9	34	M8x10	7	12	M6x1.0P	28	26
GR35 TA	70	104.0	48	50	10	79.0	50	13	39	M8x12	8	12	M6x1.0P	34	29
GR35 SA	70	70.5	48	50	10	45.5	-	13	39	M8x12	8	12	M6x1.0P	34	29

Altura (M ₁)	Passo (F)	B ₂	B ₃	dxDxh	C kgf	C ₀ kgf	M _A kgf-m	M _B kgf-m	M _C kgf-m	Bloco (Kg/peça)	Trilho (kg/m)
15	60	7.5	16	4.5x7.5x5.5	850	1380	7.3	7.3	10.1	0.2	1.7
18	60	10	21.5	6x9.5x8.5	1410	2430	15.9	15.9	23.7	0.35	2.5
18	60	10	21.5	6x9.5x8.5	2170	3240	27.5	27.5	31.6	0.47	2.5
22	60	11.5	23.5	7x11x9	2030	3510	27.5	27.5	40.0	0.59	3.6
22	60	11.5	23.5	7x11x9	2770	4680	46.8	46.8	51.8	0.75	3.6
26	80	14	31	9x14x12	2860	4770	43.8	43.8	65.8	1.1	5.1
26	80	14	31	9x14x12	3800	6370	74.4	74.4	87.7	1.3	5.1
29	80	17	33	9x14x12	3800	6230	65.4	65.4	104.7	1.6	6.9
29	80	17	33	9x14x12	5120	8310	111.1	111.1	139.9	2.0	6.9
38	105	22.5	37.5	14x20x17	6120	9750	127.6	127.6	213.2	2.8	11.0
38	105	22.5	37.5	14x20x17	8200	13000	217.1	217.1	284.1	3.3	11.0

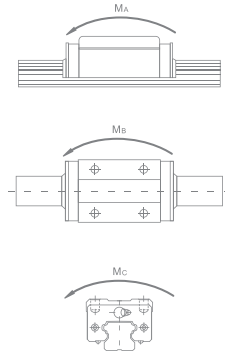

Passo (F)	B ₂	B ₃	dxDxh	C kgf	C ₀ kgf	M _A kgf-m	M _B kgf-m	M _C kgf-m	Bloco (Kg/peça)	Trilho (kg/m)
60	7.5	9.5	4.5x7.5x5.5	850	1380	7.3	7.3	10.1	0.18	1.7
60	10	12	6x9.5x8.5	1410	2430	15.9	15.9	23.7	0.25	2.5
60	10	12	6x9.5x8.5	2170	3240	27.5	27.5	31.6	0.35	2.5
60	11.5	12.5	7x11x9	2030	3510	27.5	27.5	40.0	0.54	3.6
60	11.5	12.5	7x11x9	2770	4680	46.8	46.8	51.8	0.67	3.6
80	14	16	9x14x12	2860	4770	43.8	43.8	65.8	0.9	5.1
80	14	16	9x14x12	3800	6370	74.4	74.4	87.7	1.1	5.1
80	17	18	9x14x12	3800	6230	65.4	65.4	104.7	1.5	6.9
80	17	18	9x14x12	5120	8310	111.1	111.1	139.9	2.0	6.9
105	22.5	20.5	14x20x17	6120	9750	127.6	127.6	213.2	2.6	11.0
105	22.5	20.5	14x20x17	8200	13000	217.1	217.1	284.1	3.1	11.0

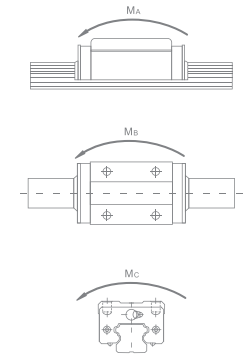

Passo (F)	B ₂	B ₃	dxDxh	C kgf	C ₀ kgf	M _A kgf-m	M _B kgf-m	M _C kgf-m	Bloco (Kg/peça)	Trilho (kg/m)
60	7.5	9.5	4.5x7.5x5.5	850	1380	7.3	7.3	10.1	0.18	1.7
60	7.5	9.5	4.5x7.5x5.5	550	1132	2.04	2.04	4.08	0.11	1.7
60	10	11	6x9.5x8.5	1410	2430	15.9	15.9	23.7	0.25	2.5
60	10	11	6x9.5x8.5	730	1468	3.06	2.04	7.14	0.23	2.5
60	11.5	12.5	7x11x9	2030	3510	27.5	27.5	40.0	0.54	3.6
60	11.5	12.5	7x11x9	1190	2295	5.1	4.08	12.24	0.45	3.6
80	14	16	9x14x12	2860	4770	43.8	43.8	65.8	0.9	5.1
80	14	16	9x14x12	1754	3315	9.18	8.16	21.42	0.7	5.1
80	17	18	9x14x12	3800	6230	40.8	34.68	61.2	1.5	6.9
80	17	18	9x14x12	2428	4498	14.28	12.24	34.68	1.2	6.9

