

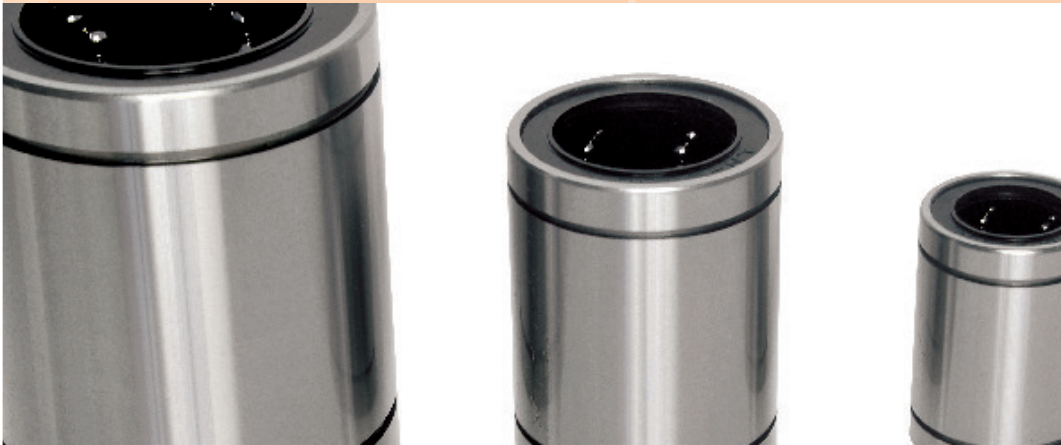

Rolamento Linear

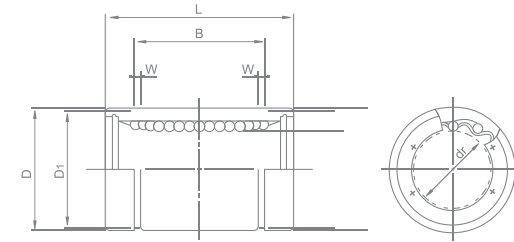

Rolamento Linear

Modelo LM	Dimensões										Cargas		Folga		
	Circuitos	dr (mm)	Tolerância (μm)	D (mm)	Tolerância (μm)	L (mm)	Tolerância (mm)	B (mm)	Tolerância (mm)	W (mm)	D ₁ (mm)	Din. C (N)	Est. C _p (N)	Tolerância (μm)	Peso (g)
LM8UU	4	8	0 -0.009	15	0 -0.011	24	0 -0.2	17,5	0 -0.2	1,1	14,3	265	402	-5	16
LM10UU	4	10		19	0 -0.013	29		22		1,3	18	373	549	-5	30
LM12UU	4	12		21	0 -0.016	30		23		1,3	12	412	598	-5	31,5
LM13UU	4	13	23	0 -0.019	32	23	1,3	22	510	775	-7	43			
LM16UU	5	16	28	0 -0.024	37	26,5	1,6	27	775	1180	-7	69			
LM20UU	5	20	32	0 -0.029	42	30,5	1,6	30,5	863	1370	-9	87			
LM25UU	6	25	40	0 -0.036	59	41	1,85	38	980	1570	-9	220			
LM30UU	6	30	45	0 -0.042	64	44,5	1,85	43	1570	2750	-9	250			
LM35UU	6	35	52	0 -0.049	70	49,5	2,1	49	1670	3140	-13	390			
LM40UU	6	40	60	0 -0.058	80	60,5	2,1	57	2160	4020	-13	585			
LM50UU	6	50	80	0 -0.077	100	74	2,6	76,5	3820	7940	-13	1580			
LM60UU	6	60	90	0 -0.096	110	85	3,15	86,5	4710	10000	-16	2000			

Modelo LME	Dimensões										Cargas		Folga		
	Circuitos	dr (mm)	Tolerância (μm)	D (mm)	Tolerância (μm)	L (mm)	Tolerância (mm)	B (mm)	Tolerância (mm)	W (mm)	D ₁ (mm)	Din. C (N)	Est. C _p (N)	Tolerância (μm)	Peso (g)
LME8UU	4	8	+0.008 0	16	0 -0.008	25	0 -0.2	16,5	0 -0.2	1,1	15,2	265	402	-5	20
LME12UU	4	12	22	0 -0.009	32	22,9		1,3		21	510	775	-7	41	
LME16UU	5	16	+0.009	26	0 -0.011	36		24,9		1,3	24,9	775	1180	-7	57
LME20UU	5	20	-0.001	32	0 -0.011	45	31,5	1,6	30,3	863	1370	-9	91		
LME25UU	6	25	+0.011	40	0 -0.011	58	44,1	1,85	37,5	980	1570	-9	215		
LME30UU	6	30	-0.001	47	0 -0.013	68	52,1	1,85	44,5	1570	2750	-9	325		
LME40UU	6	40	+0.013	62	0 -0.013	80	60,6	2,15	59	2160	4020	-13	705		
LME50UU	6	50	-0.002	75	0 -0.015	100	77,6	2,65	72	3820	7940	-13	1130		
LME60UU	6	60	90	0 -0.015	125	101,7	3,15	86,5	4710	10000	-16	2220			
LME80UU	6	80	+0.016 -0.004	120	0 -0.015	165	133,7	4,15	116	7350	16000	-16	5140		